

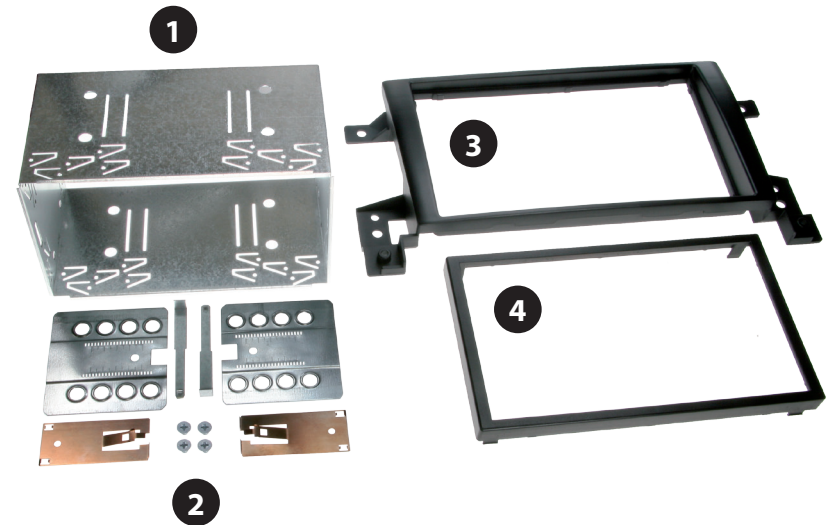

• Suzuki Grand Vitara 2005->

Compatible with these double DIN devices

Double DIN Navigation



Double DIN Set contents

- (1) Metal Frame
- (2) Install Kit
- (3) Facia Plate
- (4) Trim Frame

Installation Manual Double DIN Kit



1. Unclip and remove panels at left and right side



2. Remove screws



3. Remove OEM head unit

Installation Manual Double DIN Kit

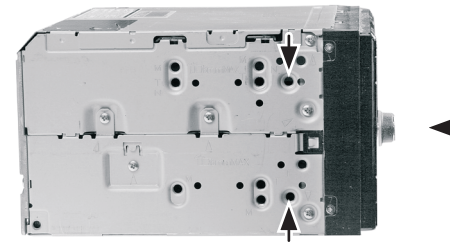

(sample photo)

Mount the metal brackets to double DIN head unit.

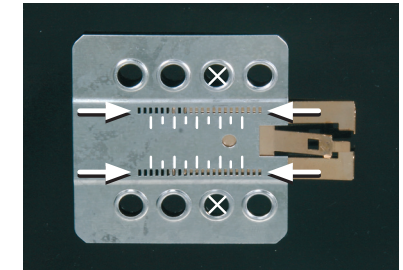

(sample photo)

The position of the copper coloured holder can be adjusted to your needs for perfect fit. (see sample)



4. Place metal frame

Connect all required circuit points and push double DIN head unit in metal frame until it snaps in.

Place the trim frame.



5. Place panels left and right to finish installation